

## 1

Download the Plume app from either the Apple Store or Google Play. Next, launch the app.

## 2

Choose “Set up Plume”, then enter your name and email to create your Plume account. Passwords must be at least 8 characters.

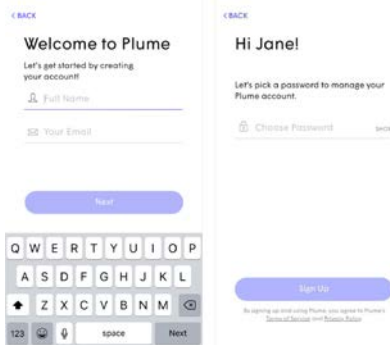

## 3

Check your email and verify the email account that will be associated with your new Plume account.

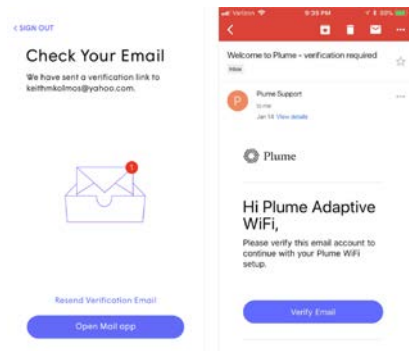

## 4

Next, there are a few steps to set up your SuperPod®. There is an option for Advanced setup, if needed.

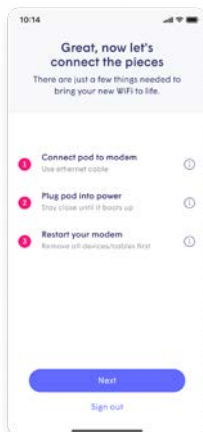

## 5

Enter your WiFi name and password. Follow the helpful on-screen tips for additional SuperPod placement.

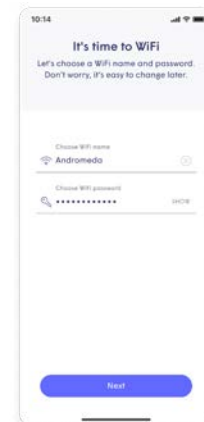

6

If you have more than one SuperPod, plug it in and add it to your network now.

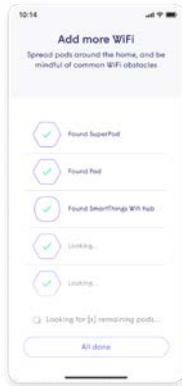

7

Be able to enable notifications. This will help you be aware of your home network activity.

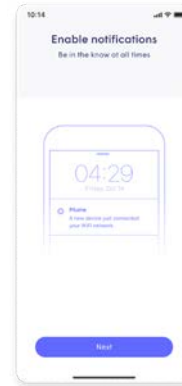

8

Your Plume membership will begin with a cloud update to ensure your Pods have the latest firmware.



9

Finally, after you've allowed Plume to join your network, you'll be taken to the home screen.

Over the next 24 hours, your new GPC Whole Home WiFi network will optimize to create the best performance for your devices.



866-382-4968



[ETCZONE.COM/INTERNET/WHOLE-HOME-WI-FI](http://ETCZONE.COM/INTERNET/WHOLE-HOME-WI-FI)

